

CONNECTION DIAGRAMS FOR RUSSOUND® MODEL A-KP2. REFER TO THE INSTRUCTIONS ON BACK. *DIAGRAMS ARE NOT TO SCALE.*

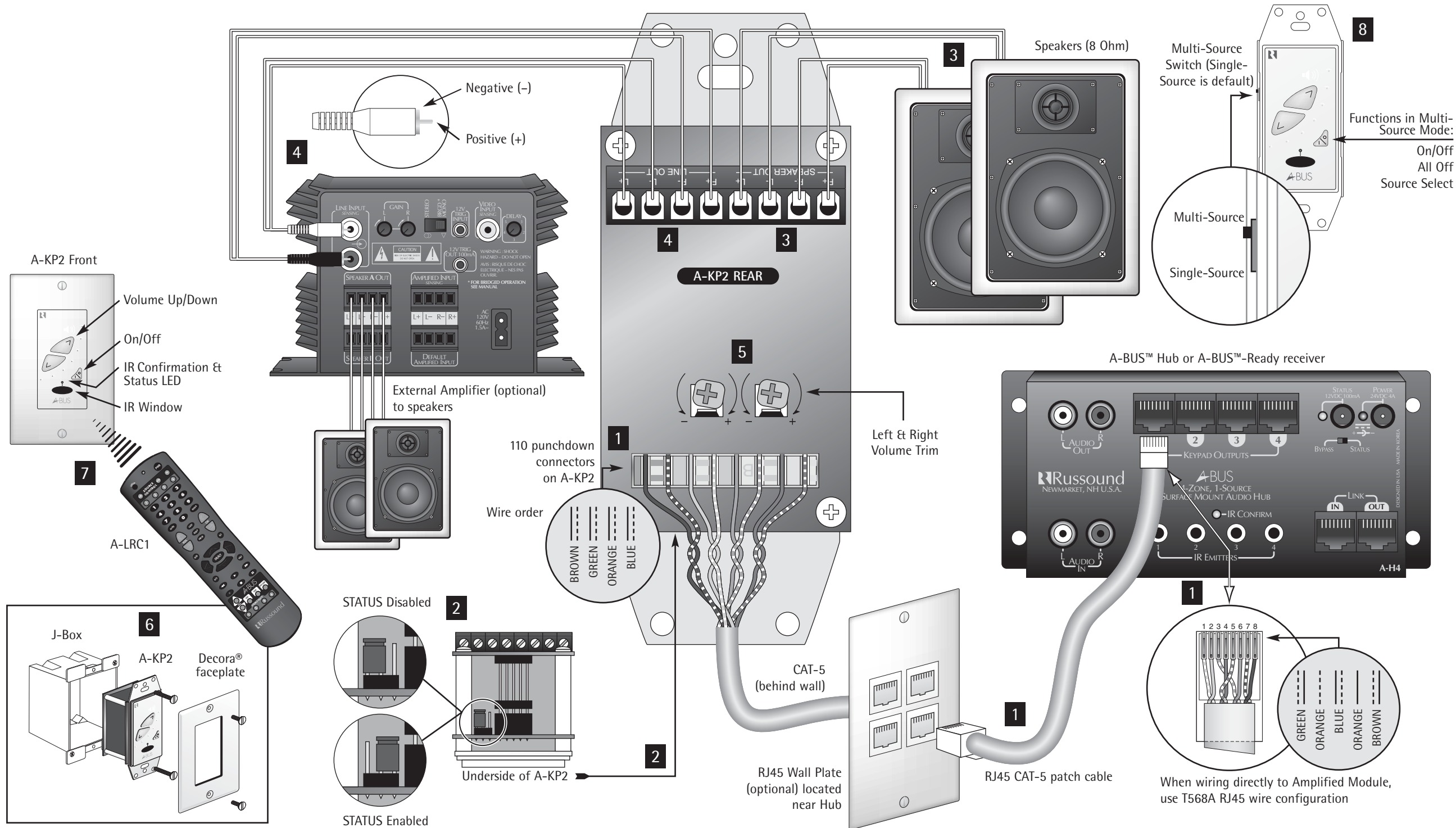

INSTALLATION NOTES

- Before connecting the A-KP2:
 - Make sure that the A-PS power supply is not connected to the A-BUS™ Hub or, if you are using an A-BUS™-Ready receiver, that the receiver is off.
 - Make sure that the STATUS input on the A-BUS™ Hub is not connected.
- The recommended maximum length for use with standard CAT-5 cable is 250 feet.
- Once all of the connections have been made, the A-PS power supply can be connected to the A-BUS™ Hub or, if you are using an A-BUS™-Ready receiver, the receiver may be turned on.
- Make any Volume Trim adjustments on the A-KP2 before installing it into the wall.

1 CAT-5 CONNECTIONS

A CAT-5 cable is used to connect the A-KP2 to a keypad output on an A-BUS™ Hub or A-BUS™-Ready receiver. For clean installations, use RJ45 CAT-5 patch cables to connect from the Hub to an RJ45 Wall Plate (optional), and then wire from the Wall Plate to the Amplified Module (see diagram). The Amplified Modules have 110 punchdown connectors for the 8 individual conductors of the CAT-5 cable (use a punchdown tool with a 110 blade to insert conductors).

NOTE: When wiring directly to an Amplified Module (i.e., not using an RJ45 Wall Plate) use T568A RJ45 wire configuration for connection to the hub.

2 STATUS

The STATUS jumper is located on the underside of the A-KP2. All A-BUS™ components are shipped with the STATUS feature disabled. If you intend to use the STATUS feature with your A-BUS™ system, you must enable the STATUS jumper on every Amplified Module as well as on the A-BUS™ Hub.

3 SPEAKER CONNECTIONS

Connect speaker wires to the speaker output terminals on the A-KP2 as shown in the diagram. The A-KP2 is designed for one pair of 8 Ohm speakers.

4 EXTERNAL AMPLIFIER (OPTIONAL)

An external amplifier can be connected to the LINE OUT of the A-KP2 to provide more power in a large listening area, such as an outdoor patio. The LINE OUT can also be used to feed a powered subwoofer for extended bass response. This output is variably controlled by A-KP2 volume.

5 VOLUME TRIM

Two rotary trim potentiometers are located on the back of the A-KP2. These can be used to set the maximum allowable volume level and to adjust left/right balance. Use a Philips-head screwdriver.

6 MOUNTING

Check all connections and test the system's operation before installing the A-KP2 into the wall. Using the included hardware, install the A-KP2 into a standard UL/CSA approved electrical J-Box as shown.

7 OPERATION

- Power On/Off source select and volume level can be controlled using the buttons on the A-KP2 or by using the optional A-LRC1 remote control. The A-KP2 will always reset to a low volume level when turned on.
- If you have installed IR Emitters in your A-BUS™ system, then sources can be operated with their own remote (or a "universal" remote) by aiming it at the IR window on the A-KP2.
- When the A-KP2 receives infrared signals from a remote control, the LED indicator will flash red.
- If you are using the STATUS feature in your A-BUS™ system, the LED indicator on the A-KP2 will illuminate green when your source equipment is on, even when the A-KP2 is off.

8 MULTI-SOURCE MODE SWITCH

The Multi-Source Mode Switch should be set to Single-Source when using the A-KP2 with Single-Source A-BUS™ hubs. The Switch should be set to Multi-Source when using the A-KP2 with Multi-Source A-BUS™ hubs.

9 MULTI-SOURCE OPERATION

Source Selection:

- Tapping the power button will allow you to toggle between multiple sources once the initial press for power "on" is performed. The top 4 LEDs of the volume indicator will show the source that is selected.

Zone (Keypad) Off:

- Press and hold the power button until the keypad turns off.

System (Hub) Off:

- When the keypad is off, press and hold the power button until the Green LED blinks Red and turns off.

Other Functions:

- Source selection and all other functions of the A-KP2 can be made using the A-LRC1 hand-held remote.

English

A-BUS™

Model A-KP2 with Multi-Source Select Capability Amplified Keypad Module for A-BUS™ System Instruction Manual

A-BUS™ SYSTEM OVERVIEW

The product you have just purchased is an integral part of the Russound® A-BUS™ Multi-Room Audio System. It is a component which, when combined with other essential components and your source equipment (receiver, CD player, etc.), creates a versatile whole-house audio system that will fill your rooms with high-quality sound for years to come.

A-BUS™ technology is a new, innovative method of providing high quality audio to remote locations with a single 8-conductor cable such as CAT-5. A-BUS™ technology provides many advantages over other methods of audio distribution, including: simple, single CAT-5 wiring scheme; infrared control of system components; infrared control of the optional A-KP2 amplified keypad module; and system power status.

Every A-BUS™ System is comprised of components from each of the following three areas.

1. **A-BUS™ Amplified Modules:** The Module contains both the amplifier for the room's speakers as well as the control for those speakers. One Module should be used for each room you choose to control. The Russound® A-KP2 Amplified Keypad (with built-in IR receiver) and A-VC2 Amplified Volume Control are examples of A-BUS™ Amplified Modules.
2. **A-BUS™ Hubs:** All components of the A-BUS™ system must be wired centrally to a Hub located near your source equipment. The Hub provides the connection for source equipment, volume controls, infrared emitters and power supply. The A-H484, A-H4, A-H4D, and A-H2 are examples of A-BUS™ Hubs. The A-H484, A-H4, and A-H2 are surface-mount units. The A-H4D is an in-wall Decora® style unit.
3. **Power Supply:** The power supply plugs into the Hub. The Russound® A-PS 24VDC/2.5A unit is an example.

A-BUS™ is a registered trademark of LeisureTech Electronics Pty Ltd

Decora® is a trademark of Leviton Corporation

Russound®
A/V DISTRIBUTION & CONTROL SYSTEMS

5 Forbes Rd. Newmarket, NH 03857, USA
☎ 603.659.5170 • Fax 603.659.5388
e-mail: tech@russound.com

the right
connection

Come visit us at:

www.russound.com

A-KP2 OVERVIEW

The A-KP2 is an in-wall, A-BUS™ Amplified Module with push-buttons for speaker volume level and power On/Off source select as well as an IR window for receiving remote control signals. The A-KP2 connects to A-BUS™ Hubs or A-BUS™-Ready receivers using CAT-5 wiring, and to loudspeakers using conventional speaker wire.

IMPORTANT – Before installation, review the manuals included with each component in your system. If you are unsure of any of the installation procedures described herein or elsewhere, consult a professional electronics installer.

A-KP2 FEATURES

- 1) Power On/Off source select button
- 2) Volume Up/Down buttons
- 3) Built-in IR receiver
- 4) IR control of volume and On/Off source select via optional A-LRC1 remote
- 5) IR control of source components in an A-BUS™ system that uses IR Emitters
- 6) LED indicator for IR confirmation and source component on/off status
- 7) Volume Trims for setting max. allowable level and L/R balance
- 8) Line Out for connecting to external amp or powered subwoofer
- 9) Decora® faceplate

A-KP2 SPECIFICATIONS

Output Impedance:	8 Ohm per channel (1 pair of speakers)
Input Impedance:	28k Ohm min., line input
Power Requirements:	+24VDC, 750mA
Status Input Reqs.:	+12VDC, 20mA
CAT-5 Connection:	110 Punchdown
Dimensions (in-wall):	1.75"W x 2.875"H x 1.75"D (45x73x45mm)
Weight:	6 oz. (170g)



Conforms to
UL 6500
Certified to
CAN/CSA
E65-94



LIMITED WARRANTY

The Russound® A-KP2 is fully guaranteed for Two (2) years from the date of purchase against all defects in materials and workmanship. During this period Russound® will replace any defective parts and correct any defect in workmanship without charge for either parts or labor. For this warranty to apply, the unit must be installed and used according to its written instructions. If service is necessary, it must be performed by Russound®. The unit must be returned to Russound® at the owner's expense and with prior written permission. Accidental damage and shipping damage are not considered defects under the terms of the warranty. Russound® assumes no responsibility for defects resulting from abuse or servicing performed by an agency or person not specifically authorized in writing by Russound®. Damage to or destruction of components due to improper use voids the warranty. In these cases the repair will be made at the owner's expense. To return for repairs, the unit must be shipped to Russound® at the owner's expense, along with a note explaining the nature of the service required. Be sure to pack in a corrugated container with at least 3 inches of resilient material to protect the unit from damage in transit.